

# LOTTUS HIGH SLEDGE CHAIR

enea

BY Lievore Alther Molina



## Structures

- Ø14x2 mm round cold rolled steel tube
- Polypropylene arms
- Semi-automatic steel robot welding with gas-controlled steel wire input
- UNE-EN 16139-2015

## Certificates

UNE-EN 15373:2007  
Strict public assessment 3.  
UNE-EN 16319:2013. 11012/11013:  
1989.  
ANSI BIFMA X 5.1

## Finishes

- Structure lacquered or chromed (with arms in lacquered/chromed steel, polypropylene and polished or lacquered aluminium).
- Shell in polypropylene, 2D wood or upholstery.
- Seat in polypropylene or upholstery.

## Measures

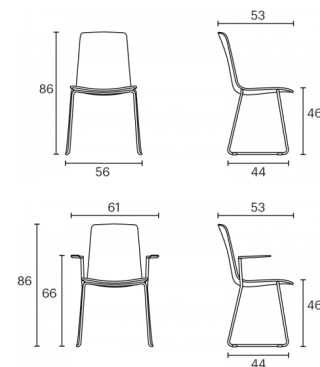

## Accessories

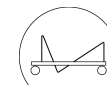

Transport and storage trolley



Transport trolley

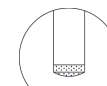

Felt foot pads

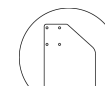

Writing table



Linking device

Lottus High sledge chair has a steel structure that comes in chrome or lacquer option in any of our colours and it has a broad range of finishes available: polypropylene shell with or without polypropylene or upholstered seat pad, or fully upholstered one. Furthermore, it is possible to add wing arms, making it suitable for different spaces.

[Click here to see all the finishes of Lottus High sledge chair](#)