

LOTTUS HIGH CHAIR

enea

BY Lievore Alther Molina



Structures

- Ø16x2 mm round cold rolled steel tube
- Semi-automatic steel robot welding with gas-controlled steel wire input
- UNE-EN 16139-2015

Certificates

UNE-EN 15373:2007
Strict public assessment 3.
UNE-EN 16319:2013. 11012/11013:
1989.
ANSI BIFMA X 5.1

Finishes

- Structure lacquered or chromed (with arms in lacquered/chromed steel, polypropylene and polished or lacquered aluminium).
- Shell in polypropylene, 2D wood or upholstery.
- Seat in polypropylene or upholstery.

Measures

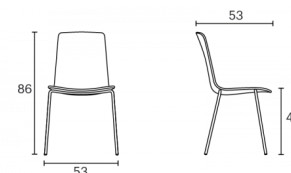

Accessories

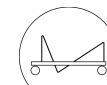

Transport
and
storage
trolley



Transport
trolley

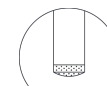

Felt foot
pads

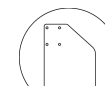

Writing
table



Linking
device

Lottus High chair has a 4-legged steel structure that comes in chrome or lacquer option in any of our colours and has a broad range of finishes available: polypropylene shell with or without polypropylene or upholstered seat pad, or fully upholstered one. All these possibilities make this chair suitable for different spaces.

[Click here to see all the finishes of Lottus High chair](#)